

No.	REVISIONS	DATE	DRAWN	APP.
①				
②				

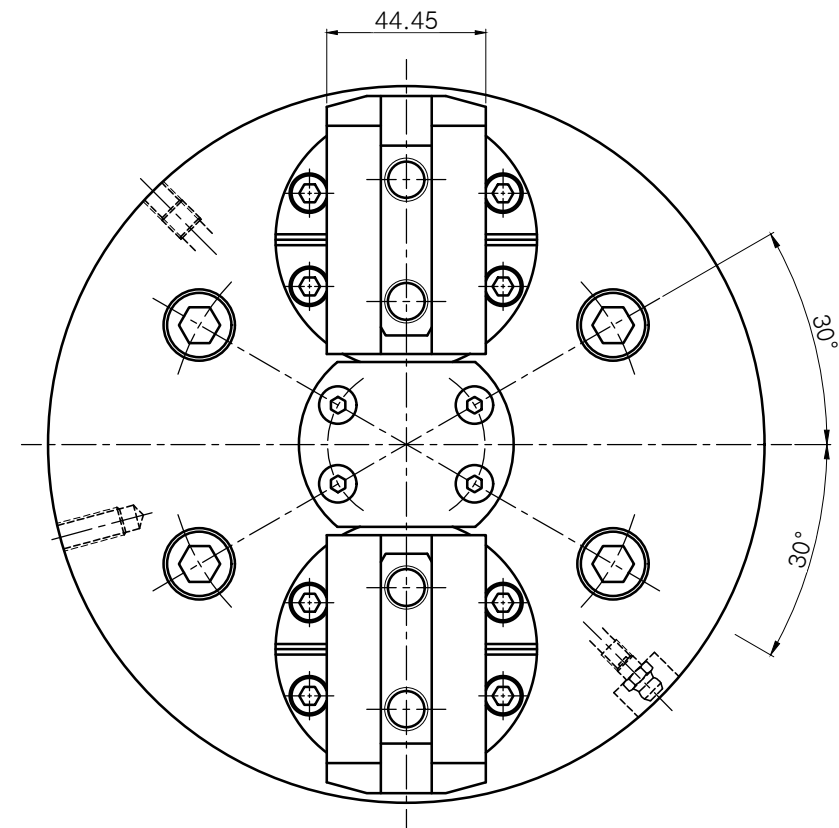
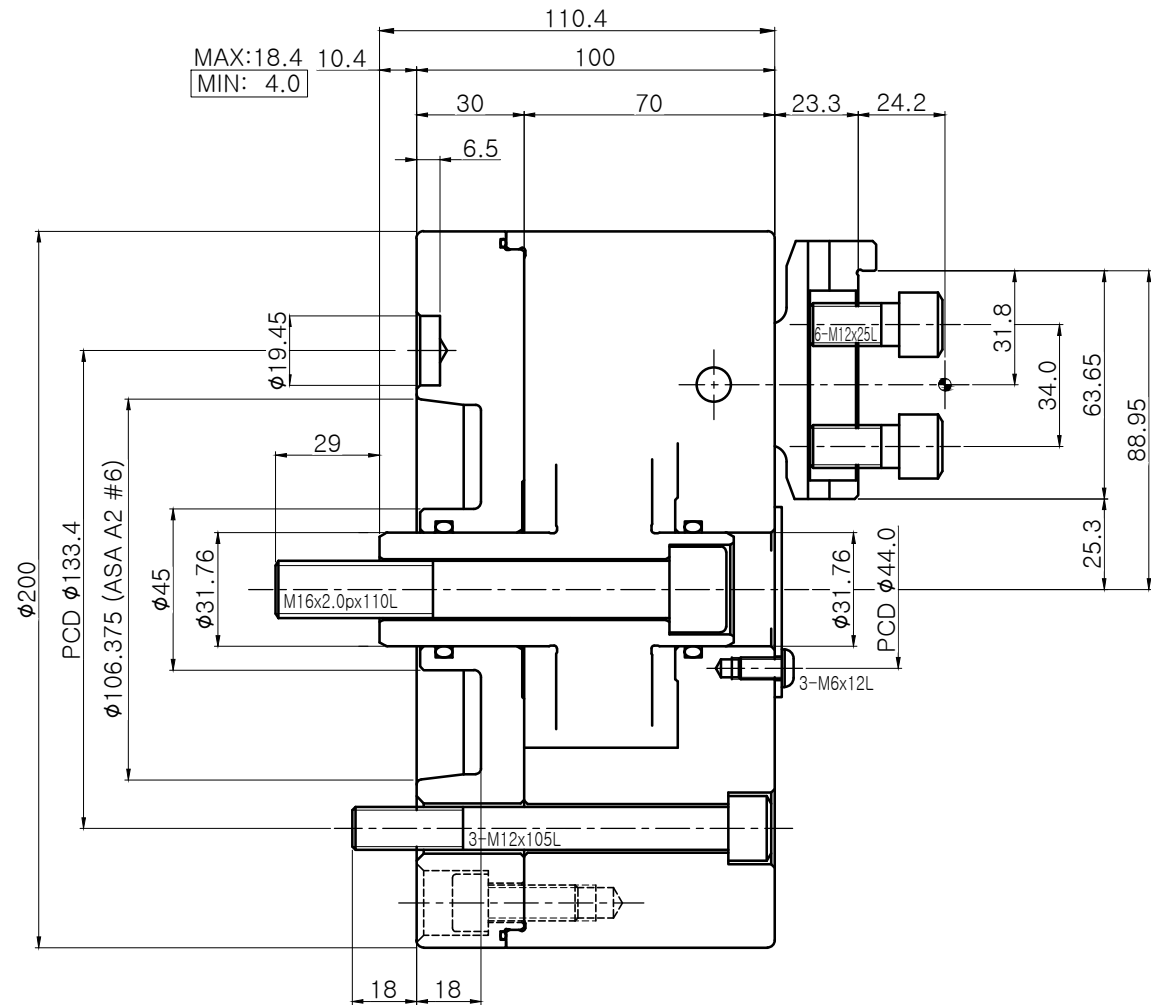

CHUCK SPEC.	
CHUCK SPEC.	PBL-08-2CT
PLUNGER STROKE	14.4 mm
JAW STROKE	9.5 mm
MAX. INPUT FORCE	1,933 kgf
CLAMPING FORCE	5,800 kgf
MAX. SPEED	3,500 rpm
MOMENT OF INERTIAL	0.48kgf.m ²
WEIGHT	27 kg

1	BLANK CHUCK	STD.	PBL-08-2CT	1SET	A2 #6
NO.	TITLE OF ITEM	MATERIAL	SIZE & SPEC.	Q'TY	NOTE
TITLE	PBL CHUCK (PBL-08-2CT)		PART NAME	ASSEMBLY DRAWING	
DWG. NO.	P082C61		AGENCY	-	
CODE NO.	-		USER	-	
			DATE	-	
SCALE	1 : 1	Approved	Checked	Designed	

No.	REVISIONS	DATE	DRAWN	APP.
1				
2				

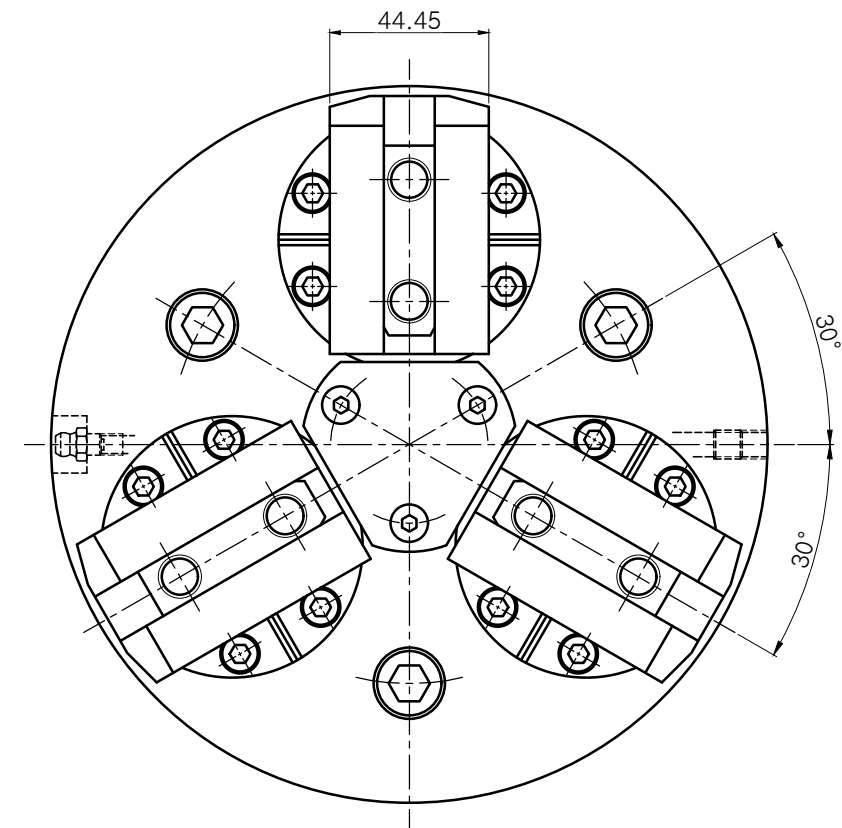
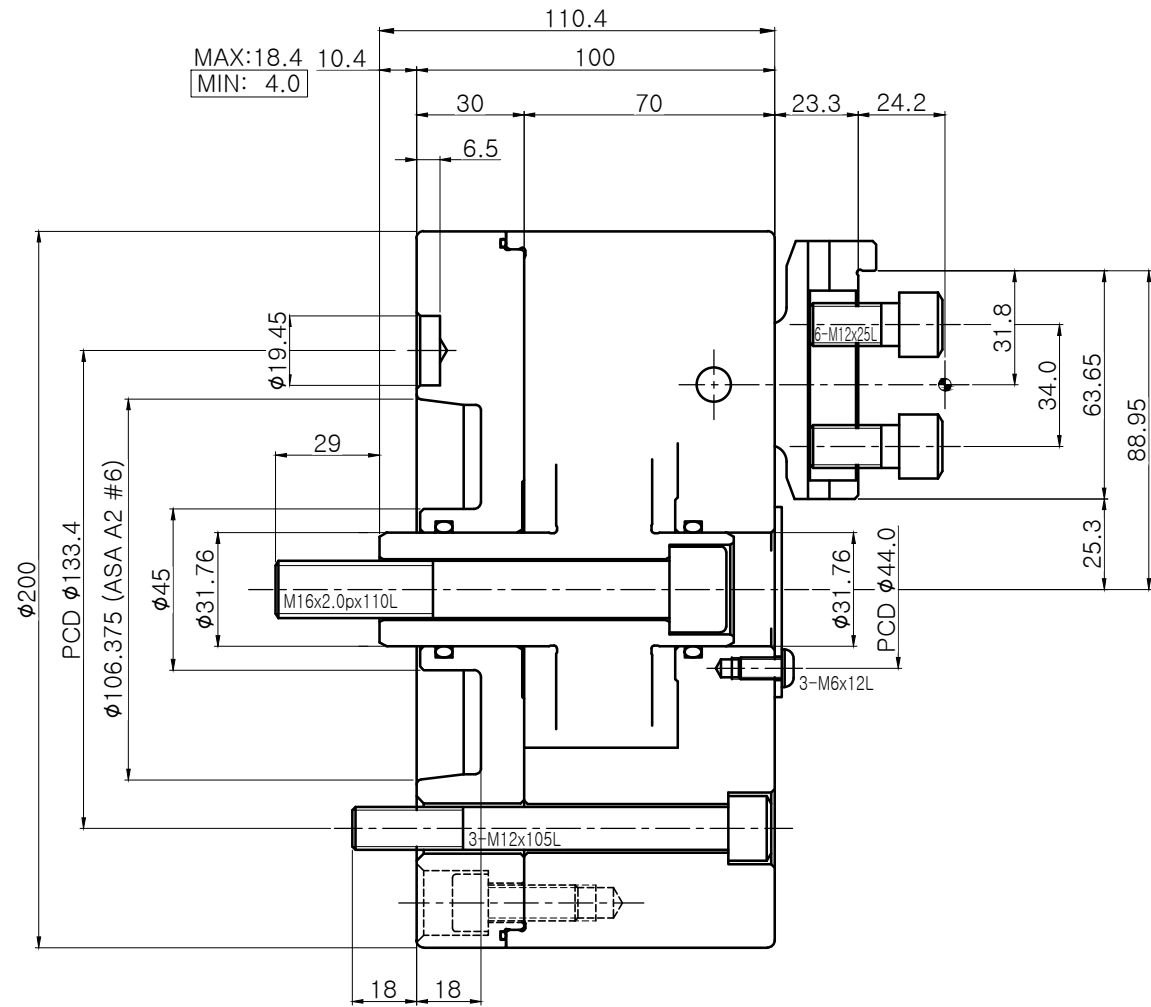

CHUCK SPEC.	
CHUCK SPEC.	PBL-08-3CT
PLUNGER STROKE	14.4 mm
JAW STROKE	9.5 mm
MAX. INPUT FORCE	2,900 kgf
CLAMPING FORCE	8,700 kgf
MAX. SPEED	3,500 rpm
MOMENT OF INERTIAL	0.48kgf.m ²
WEIGHT	27 kg

1	BLANK CHUCK	STD.	PBL-08-3CT	1SET	A2 #6
NO.	TITLE OF ITEM	MATERIAL	SIZE & SPEC.	Q'TY	NOTE
	PBL CHUCK (PBL-08-3CT)		PART NAME	ASSEMBLY DRAWING	
DWG. NO.	P083C61		AGENCY	-	
CODE NO.	-		USER	-	
			DATE	-	
SCALE	1 : 1	Approved	Checked	Designed	



No.	REVISIONS	DATE	DRAWN	APP.
①				
②				

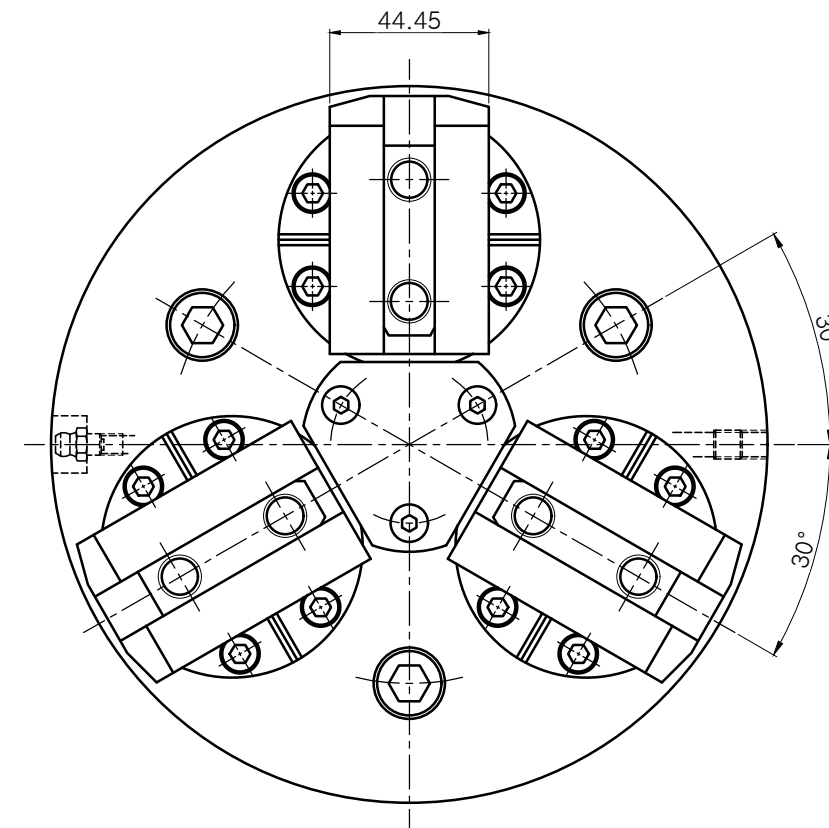
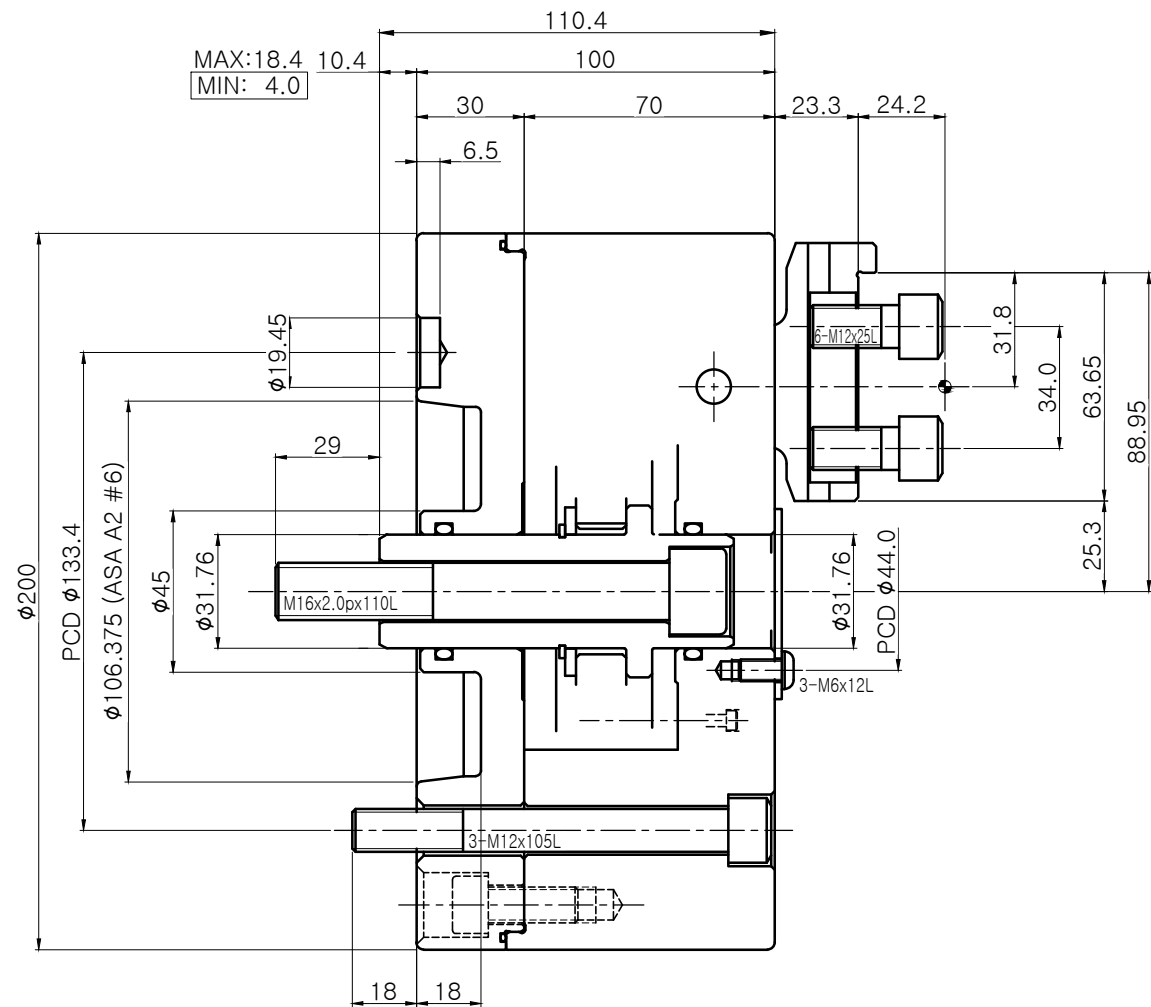

CHUCK SPEC.	
CHUCK SPEC.	PBL-08-3CP
PLUNGER STROKE	14.4 mm
JAW STROKE	9.5 mm
MAX. INPUT FORCE	2,900 kgf
CLAMPING FORCE	8,700 kgf
MAX. SPEED	3,500 rpm
MOMENT OF INERTIAL	0.48kgf.m ²
WEIGHT	27 kg

1	BLANK CHUCK	STD.	PBL-08-3CP	1SET	A2 #6
NO.	TITLE OF ITEM	MATERIAL	SIZE & SPEC.	Q'TY	NOTE
TITLE	PBL CHUCK (PBL-08-3CP)		PART NAME	ASSEMBLY DRAWING	
DWG. NO.	P083P61		AGENCY	-	
CODE NO.	-		USER	-	
			DATE	-	
SCALE	1 : 1	Approved	Checked	Designed	